



## **BASE MOUNTED MINI POST INSTALLATION INFORMATION**





## INSTALLATION INFORMATION

1) Read the plan and check if the items are correct.



2) Mark out a line as shown on the plans.



## INSTALLATION INFORMATION

- 3) Delineate the Mini-Post centrelines as per plan provided.

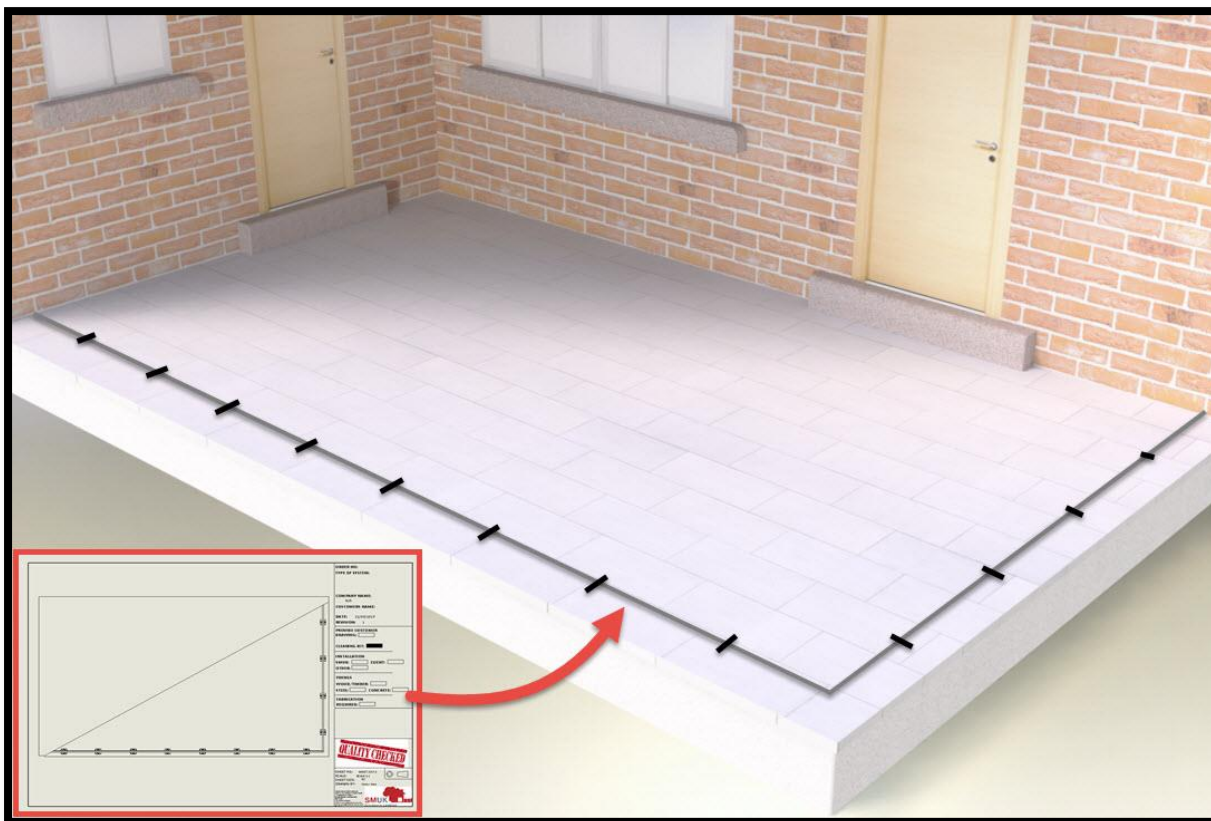

- 4) Using a template, mark hole centres and drill all holes required to suit fixings (contact us for approved fixings for concrete, brick or block work). Clean holes to remove dust.

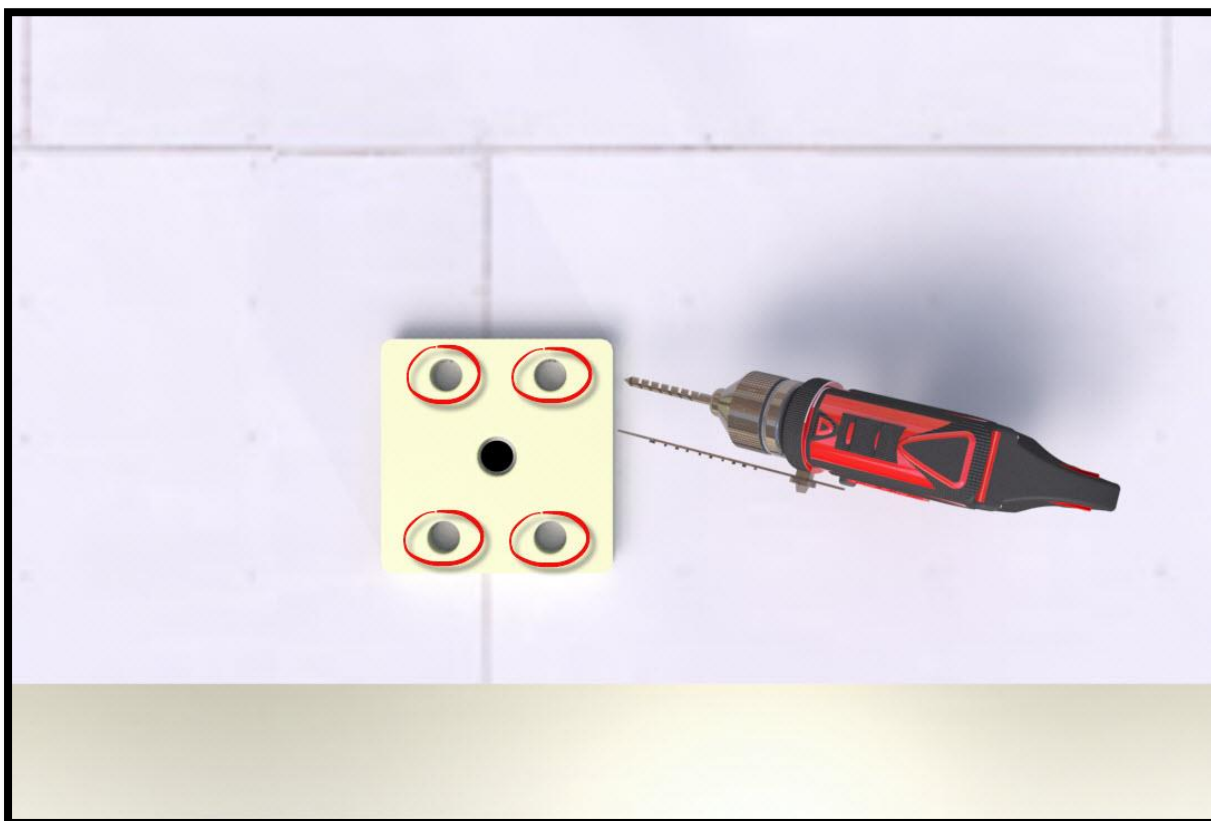

## INSTALLATION INFORMATION

5) Fix posts into position using the appropriate fixings.

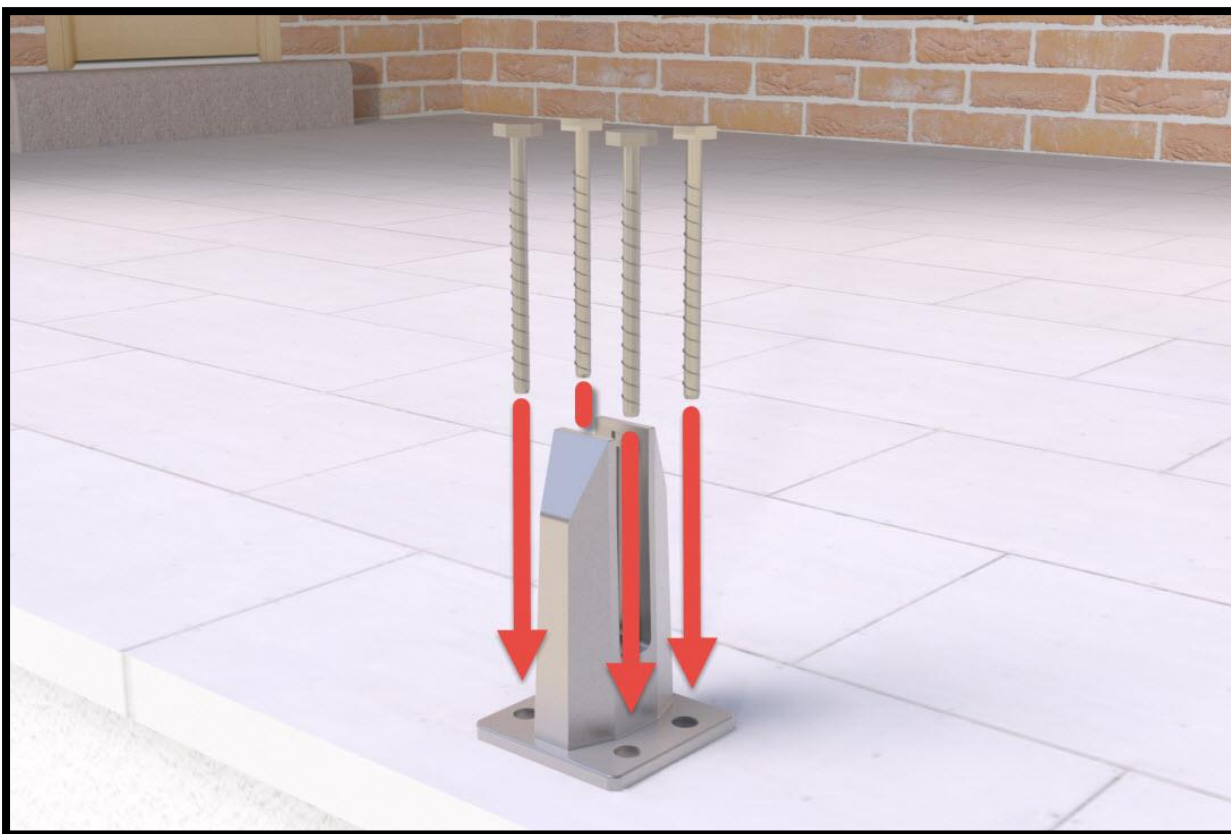

6) Slide cover plate over Mini Post.

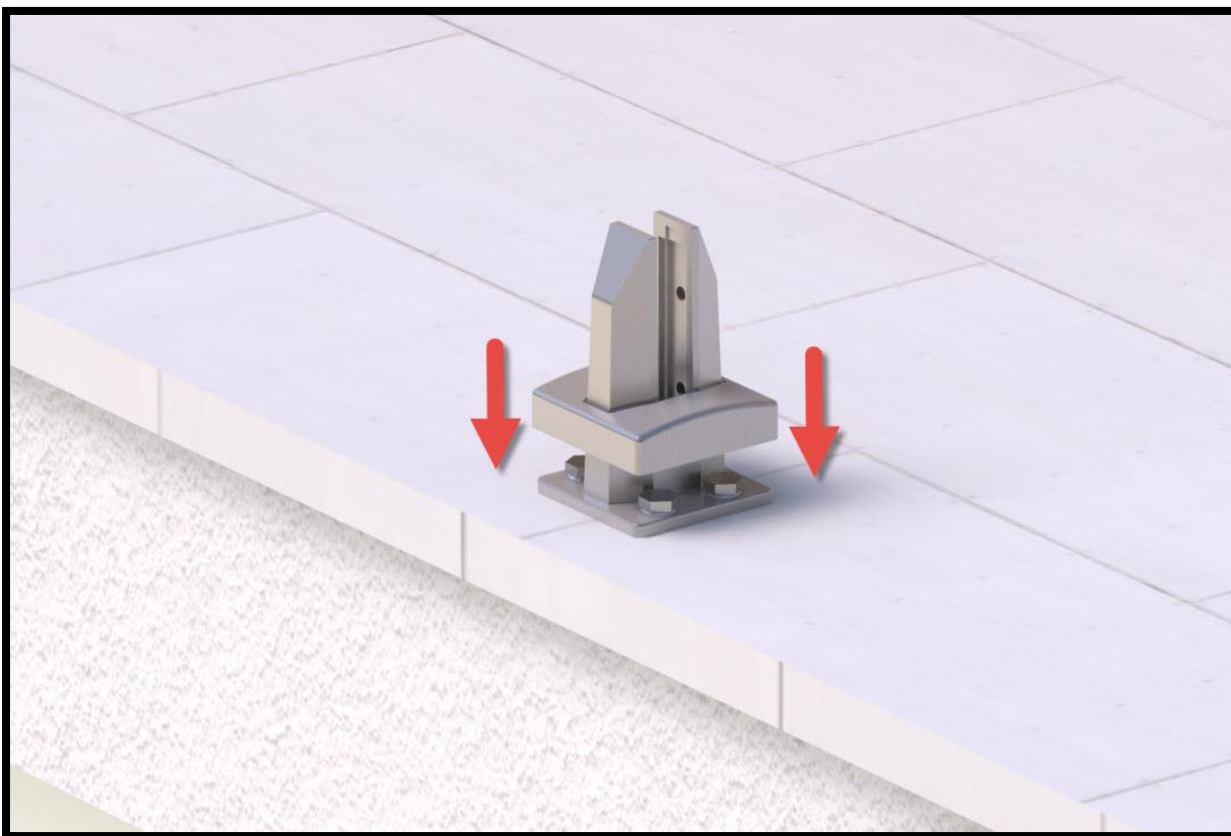

## INSTALLATION INFORMATION

- 7) Loosen grub screws with the 6mm Allen key supplied and align metal inserts into Mini Post.

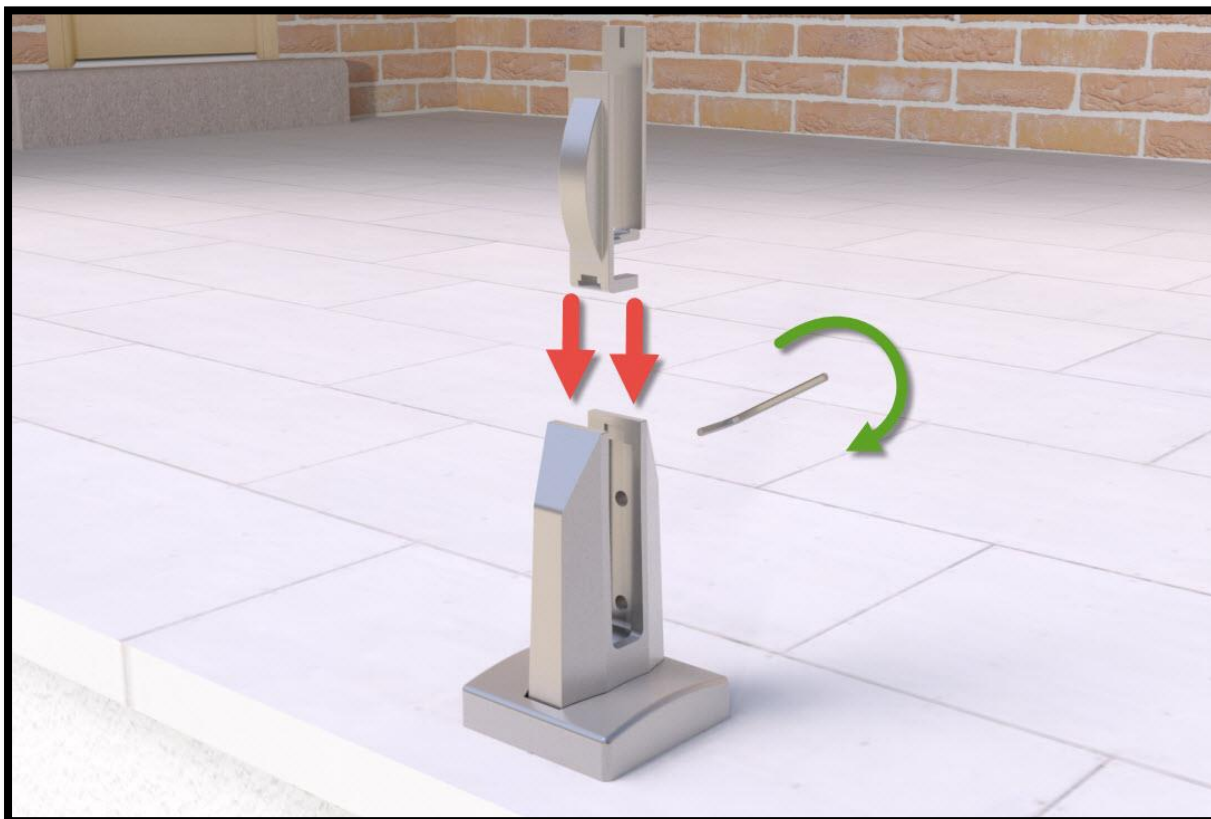

- 8) Locate the correct coloured plastic inserts for the correct glass thickness (see table).

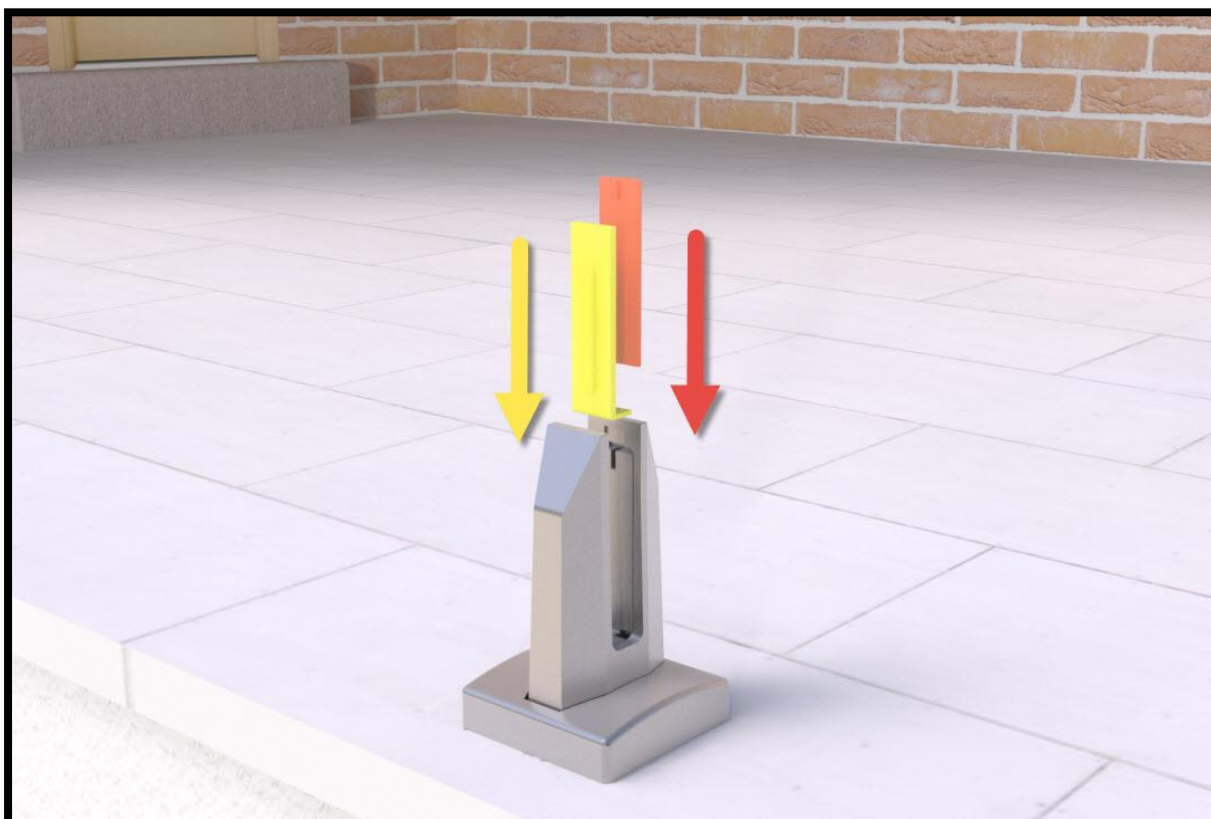

## INSTALLATION INFORMATION

- 9) Carefully lift the glass into the Mini Posts and shuffle in to position. From the centre of the Mini post the glass should overhang the Mini post by  $\frac{1}{4}$  of its width. Repeat this process leaving the required gaps between the panels.

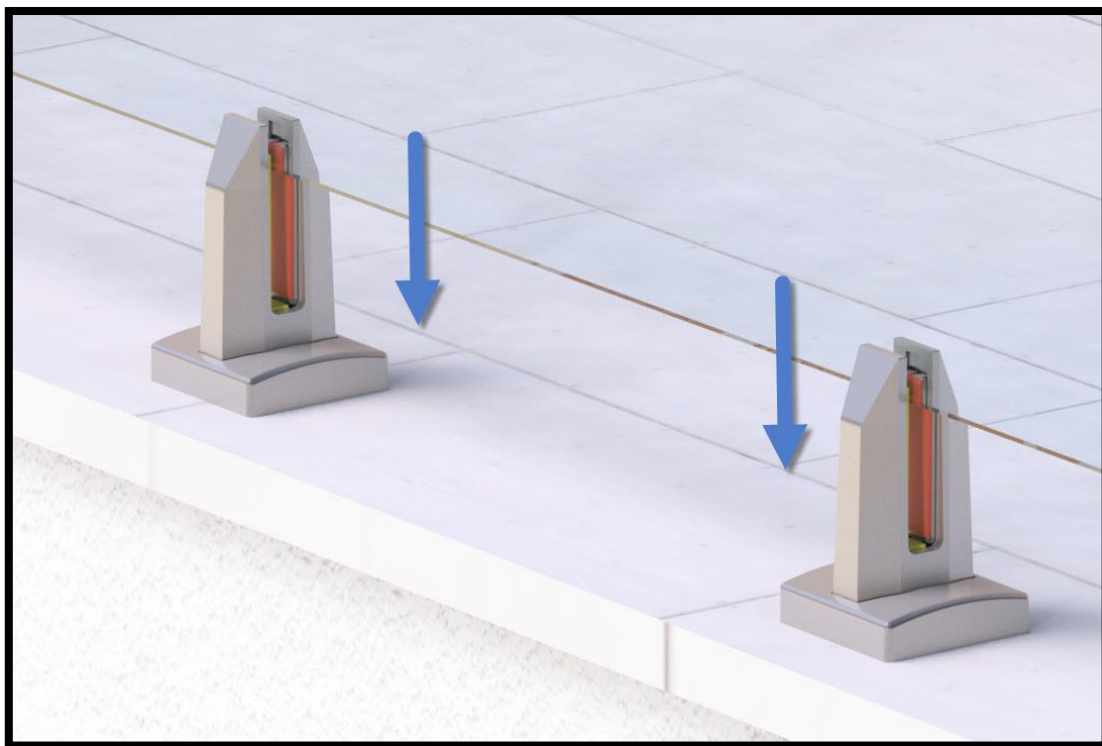

- 10) Tighten the grub screws on the front of the Mini Post using the 6mm Allen key supplied to align the glass. The bottom screw adjusts the glass inwards and the top screw outwards. Use a spirit level on front of the panel to confirm alignment. Do not over tighten grub screws.

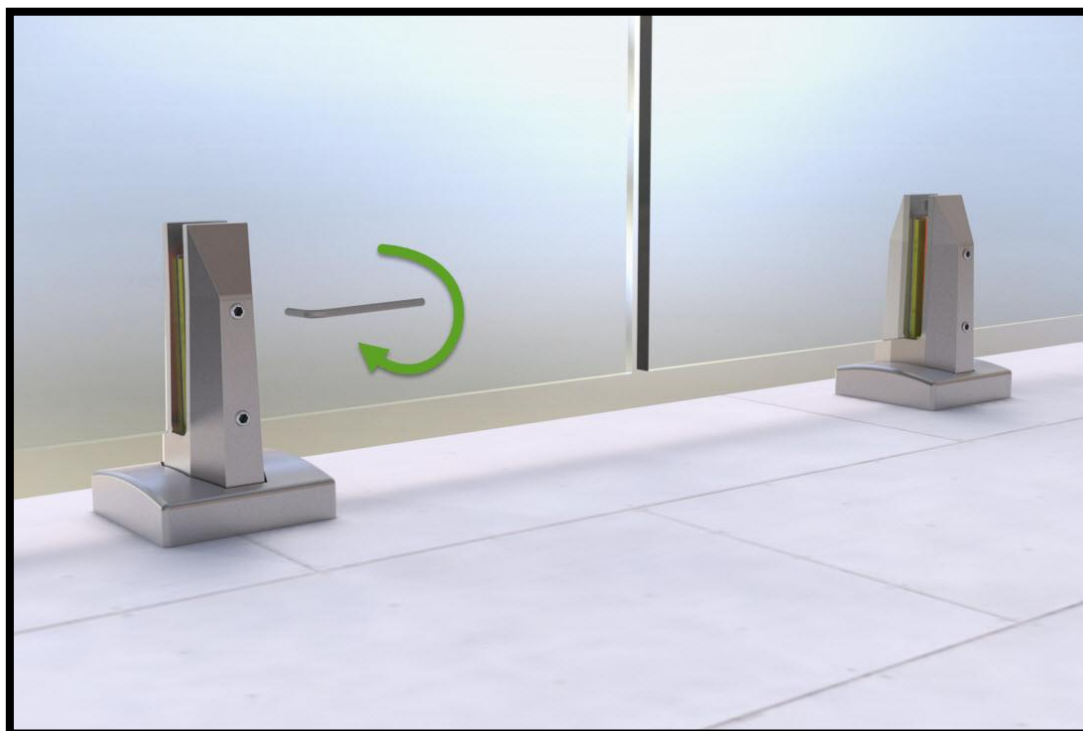

## INSTALLATION INFORMATION

- 11) Position gasket onto the top edge of the glass. Tape can be used if required to hold into position. Apply lubricant (washing up liquid recommended) to the top of the gasket.



- 12) Position handrail over gasket and gently tapped down (cover Handrail for protection if using a rubber mallet).



## INSTALLATION INFORMATION

- 13) Any wall brackets and elbows must be secured into position prior to installing handrails.

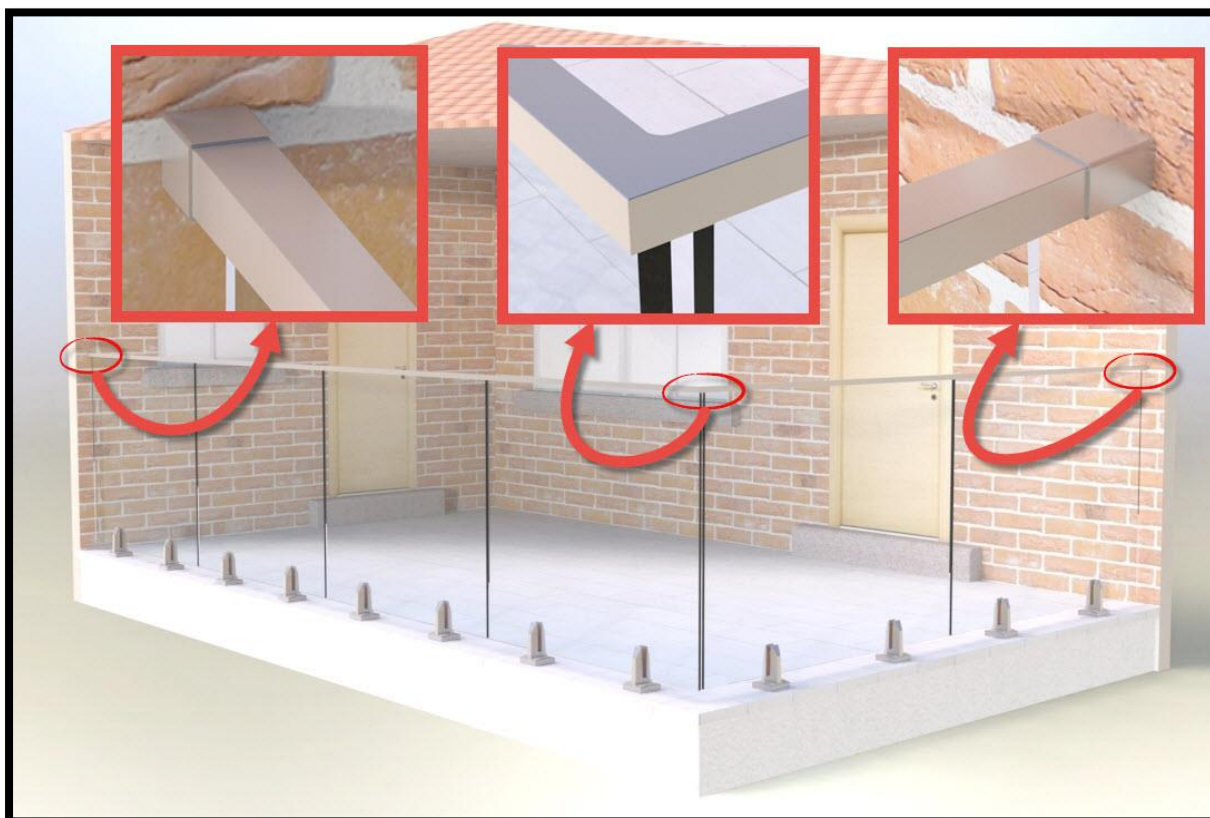

- 14) Finally, clean the glass with the cleaning kit provided and enjoy your new balustrade.

